

WHERE MEETING
MEETS YOUR PLAN



Meeting Brochure

GRAND MERCURE
MALANG MIRAMA

Grand Mercure Malang Mirama offers 11 function rooms which can accommodate up to 2200 persons in Grand Ballroom. All function rooms are facilitated with Wi-Fi Connection, LCD projector, Standard Sound System, Meeting Stationary and Personalized Events Concierge

"Make a date with our professional events planners to plan your function"

Email: info@grandmercure-malang.com Phone: +62341 438 3333

GRAND MERCURE BOARD MEETING (FULL BOARD)

Starts from
IDR 1.550.000,- net/person/day

- 1 Night stay
- 1x Breakfast
- 2 Meals (Lunch + Dinner)
- 2 Coffee Breaks
- Twin Share Basis

GRAND MERCURE BOARD MEETING (FULL BOARD)

Starts from
IDR 1.850.000,- net/person/day

- 1 Night stay
- 1x Breakfast
- 2 Meals (Lunch + Dinner)
- 2 Coffee Breaks
- Single Basis

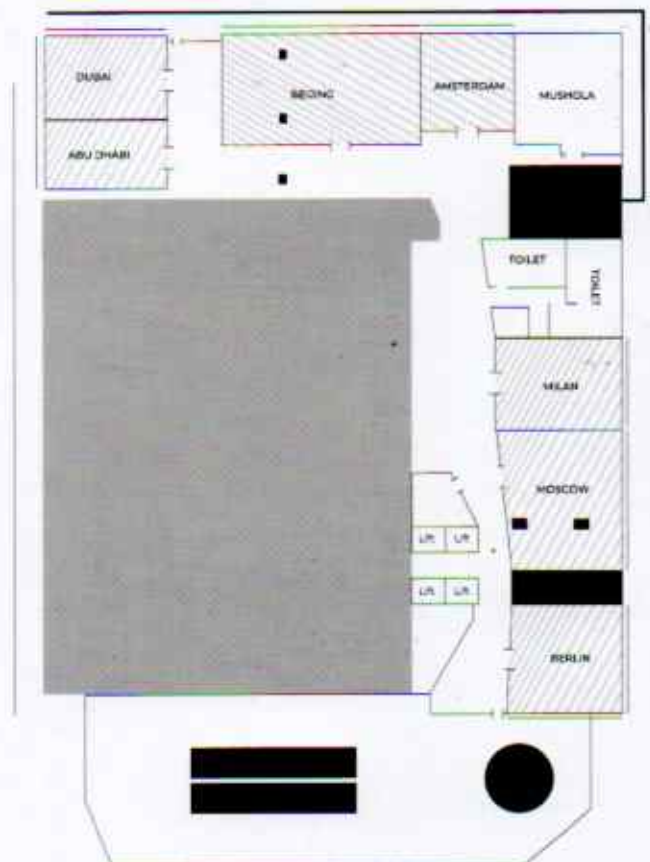
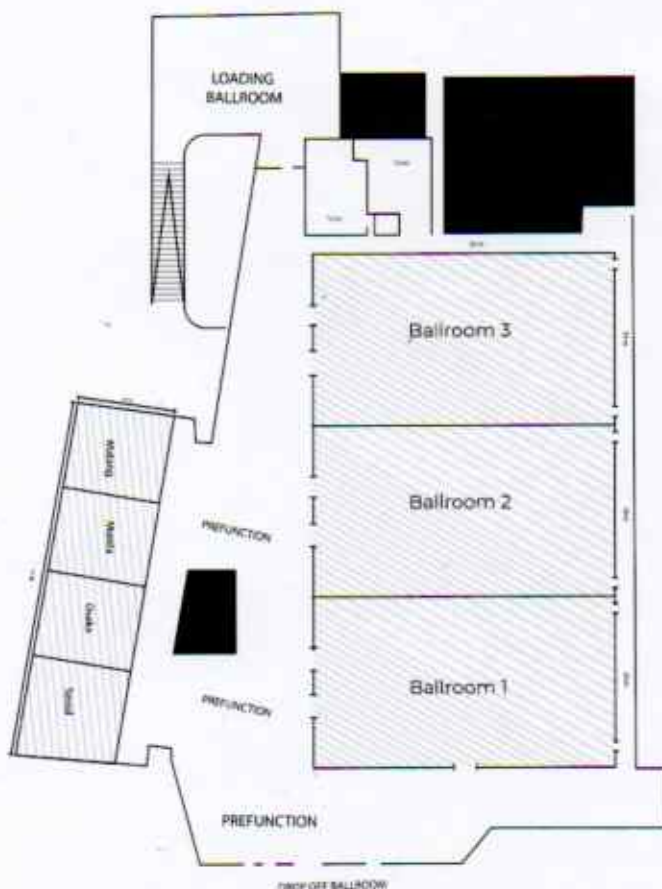

THE GRAND MEETING

ROOMS	CLASS	THEATRE	U SHAPE	STANDING	ROUND TABLE	DIMENSION (M2)
The Grand Ballroom	1000	2000	600	2200	1344	2165
Ballroom I	300	600	180	650	420	722
Ballroom II	300	600	180	650	420	716
Ballroom III	300	600	180	650	420	727
Berlin	45	90	30	90	50	108
Moscow	60	100	40	100	70	147
Milan	45	66	30	70	50	103
Amsterdam	40	70	30	40	40	77
Beijing	96	150	40	176	100	179
Abu Dabhi	50	80	40	55	50	85
Dubai	40	70	30	40	40	75
Seoul	45	90	30	90	50	100
Osaka	45	90	30	90	50	100
Manila	45	90	30	90	50	100
Malang	45	90	30	90	50	100

ROOMS	1 CB	1 LUNCH	1 DINNER	1 CB + 1L/1D	1 CB + 1L/1D	2 CBS + 1L/1D
The Grand Ballroom (min 600 persons)	200.000	275.000	300.000	350.000	425.000	580.000
Ballroom I (min 180 persons)	200.000	275.000	300.000	350.000	425.000	580.000
Ballroom II (min 180 persons)	200.000	275.000	300.000	350.000	425.000	580.000
Ballroom III (min 180 persons)	200.000	275.000	300.000	350.000	425.000	580.000
Berlin (min 30 persons)	200.000	275.000	300.000	350.000	425.000	580.000
Moscow (min 40 persons)	200.000	275.000	300.000	350.000	425.000	580.000
Milan (min 40 persons)	200.000	275.000	300.000	350.000	425.000	580.000
Amsterdam (min 30 persons)	200.000	275.000	300.000	350.000	425.000	580.000
Beijing (min 40 persons)	200.000	275.000	300.000	350.000	425.000	580.000
Abu Dabhi (min 40 persons)	200.000	275.000	300.000	350.000	425.000	580.000
Dubai (min 30 persons)	200.000	275.000	300.000	350.000	425.000	580.000
Seoul (min 30 persons)	200.000	275.000	300.000	350.000	425.000	580.000
Osaka (min 30 persons)	200.000	275.000	300.000	350.000	425.000	580.000
Manila (min 30 persons)	200.000	275.000	300.000	350.000	425.000	580.000
Malang (min 30 persons)	200.000	275.000	300.000	350.000	425.000	580.000
MAXIMUM ROOM	4 hours	4 hours	4 hours	6 hours	8 hours	10 hours

Packages Includes:

- Meeting stationeries
- Ice water and candies during meeting
- Sound system, audio and visual
- LCD Screen (2 x 2 m)
- Choice of menus
- Reception table and flower vase arrangement

ROOM RENTAL CHARGE

ROOMS	WIDTH (M)	LENGTH (M)	HEIGHT (M)	DIMENSION (M)	8 HOURS (Rp)
The Grand Ballroom	36	60	8	2165	150.000.000
Ballroom I	20	29	8	722	70.000.000
Ballroom II	20	29	8	716	70.000.000
Ballroom III	20	29	8	727	70.000.000
Berlin	9	10	3	108	12.000.000
Moscow	10	12	3	147	14.000.000
Milan	12	8	3	103	12.000.000
Amsterdam	8	8	3	77	10.000.000
Beijing	10	18	3	179	15.000.000
Abu Dabhi	7	11	3	85	10.000.000
Dubai	7	11	3	75	10.000.000
Seoul	10	10	3	100	12.000.000
Osaka	10	10	3	100	12.000.000
Manila	10	10	3	100	12.000.000
Malang	10	10	3	100	12.000.000

Room Rental fee includes facilities of:

- Meeting stationeries
- Ice water and candies during meeting
- Sound system, audio and visual
- Reception table and flower vase arrangement

Conditions:

- Overtime will be charged as follows:
 - a. 1 to 3 hours : 50% of the room rental charge
 - b. over 3 hours : 100% of the room rental charge

GRAND MERCURE MALANG MIRAMA

Jl. Raden Panji Suroso No. 7, Blimbing, Malang 65126, East Java - Indonesia
T. +62341 330 0000 - info@grandmercure-malang.com
grandmercure.com | all.accor.com

GRAND MERCURE

MALANG MIRAMA

AT GRAND MERCURE MALANG MIRAMA OUR STORIES BRING CULTURE TO LIFE

Premium hotel located on the main route through Malang, surrounded by beautiful mountains, business district and tourist attractions such as the Hawaii Waterpark Malang and many tourist destinations in Batu area.

264

guest rooms
& suites

1

grand ballroom

11

meeting rooms

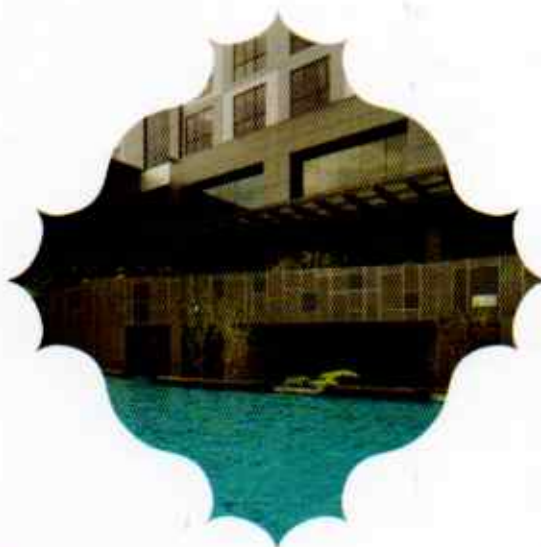

3

restaurants

1

coffee cafe

1

sky lounge

Hotel location

15 minutes from

Abdul Rachman Saleh Airport

Point of interest:

5 minutes to Araya Golf

GLORIOUS COMFORT WITH CULTURAL EXPERIENCE

This hotel features 264 rooms and suites overlooking Malang City. Enjoy ultimate comfort and spaciousness for your relaxation with All Day Dining restaurant, lobby bar, meeting rooms, swimming pool, gym, spa and sky lounge. Grand Mercure Malang Mirama is the perfect place to stay and explore the city, whether to visit historical sites or enjoy its unique cultural diversity.

HYGIENE & SAFETY GUARANTEED FOR YOUR COMFORTABLE

The most stringent hygiene standards & operational procedures in the hospitality to ensure the safety of guests while staying with us. This standard has passed inspection & certification testing by Accor operational experts or third party auditors to get the ALLSAFE label that can provide comfort during your stay.



DESTINATION MALANG

Grand Mercure Malang Mirama is premium hotel located on the main route through Malang, surrounded by beautiful mountains, business district and tourist destinations. Malang is the second largest city in East Java. It has a history dating back to the Singhasari Kingdom. During the period of Dutch colonization, it was a popular destination for European residents due to its cool climate. Malang together with its neighbouring city called Batu, has become the main destination for holiday in East Java. World-class theme parks that built here, pristine beaches on the south, and tasty culinary, bring families and friends to spend their weekends in this heart-warming city.

This is an ideal place to do business while relaxing in a dream atmosphere.

Access Mall

Mall Plaza Araya - 400 meters
Mall Olympic Garden - 7 km
Mall Malang Town Square - 8,7 km
Mall Transmart - 8,2 km

Hospital

Persada Hospital - 300 meters
Saiful Anwar Hospital - 5 km

Train Station

Blimbing Train Station - 1,5 km
Kota Malang Train Station - 5 km

Airport

Abdul Rachman Saleh Airport - 8,9 km

Grand Mercure Malang Mirama

Jl. Baden Panji Suroso No.7 Blimbing - Malang - 65126
East Java - Indonesia



This features 264 rooms and suites overlooking Malang City. Enjoy comfort and spaciousness for your relaxation:

- Trimurti All Day Dining Restaurant
- Ebisu Japanese Restaurant
- Lah Hua Chinese Restaurant
- Coffee Cafe
- Sky Lounge
- 11 Meeting Rooms
- 1 Grand Ballroom which can accommodate up to 2200 persons
- Swimming Pool
- Fitness Centre
- Spa

Our Grand Ballroom and meeting room are equipped with modern audio visual equipment and share an open veranda for prefunction activities coffee and the breaks.

The most stringent hygiene standard and operational procedures in the hospitality to ensure the safety of guests while staying with us. This standard has passed inspection and certification testing by Accor operational experts or third party auditors to get the ALLSAFE label that can provide comfort during your stay.



Deluxe Room

Modern comfortable rooms with traditional touches that will give you a new experience

Room facilities :

- 55" LCD TV
- Walk-in rain shower
- Coffee and tea facilities

60 Deluxe Rooms

180 Deluxe Executive Rooms

11 Junior Suites Rooms

11 Executive Suites Rooms

2 President Suites Rooms

LOBBY



TRIMURTI RESTAURANT



Lobby Lounge

Spacious modern Lobby Lounge , enjoy coffee and tea with a style . A perfect place for spend your day for relaxing, working and hang out with your family or colleagues.

Delight in our Culinary Style

All day dining restaurant welcomes you to share a memorable dining experience in our restaurants. Restaurant that are full of stories and have high tastes bring you new experiences.

Make reservation to our Trimurti, Ebisu & Lanhua Restaurant, to discover menu from Local, Asian, Japanese and Chinese variety of menus by our Chef.

Outdoor Swimming pool

A large and fun swimming pool for families and children, equipped with gym facilities, jacuzzi and sauna for your body fitness.



The Grand Meeting

Grand Mercure Malang Mirama offers 11 function rooms which can accommodate up to 2200 persons in Grand Ballroom. All function rooms are facilitated with Wi-Fi Connection, LCD Projectors, Standard Sound System, Meeting Stationeries and Personalized Events Concierge

Mirama Hybrid Meeting

Truly Connected with hybrid meeting with high quality technology and applications and facilitated with high Wi-Fi connection.

THE GRAND MEETING

ROOMS	CLASS	THEATRE	U/SHAP	STANDING	ROUND TABLE	DIMENSIONS (M ²)
The Grand Ballroom	1000	2000	600	2200	1344	2165
Ballroom I	300	600	180	650	420	722
Ballroom II	300	600	180	650	420	716
Ballroom III	300	600	180	650	420	727
Berlin	45	90	30	90	50	108
Moscow	60	100	40	100	70	147
Milan	45	66	30	70	50	103
Amsterdam	40	70	30	40	40	77
Beijing	96	150	40	176	100	179
Abu Dabhi	50	80	40	55	50	85
Dubai	40	70	30	40	40	75
Seoul	45	90	30	90	50	100
Osaka	45	90	30	90	50	100
Manila	45	90	30	90	50	100
Malang	45	90	30	90	50	100

